

PUBLISHED DRAFT SIDE ROADS ORDER

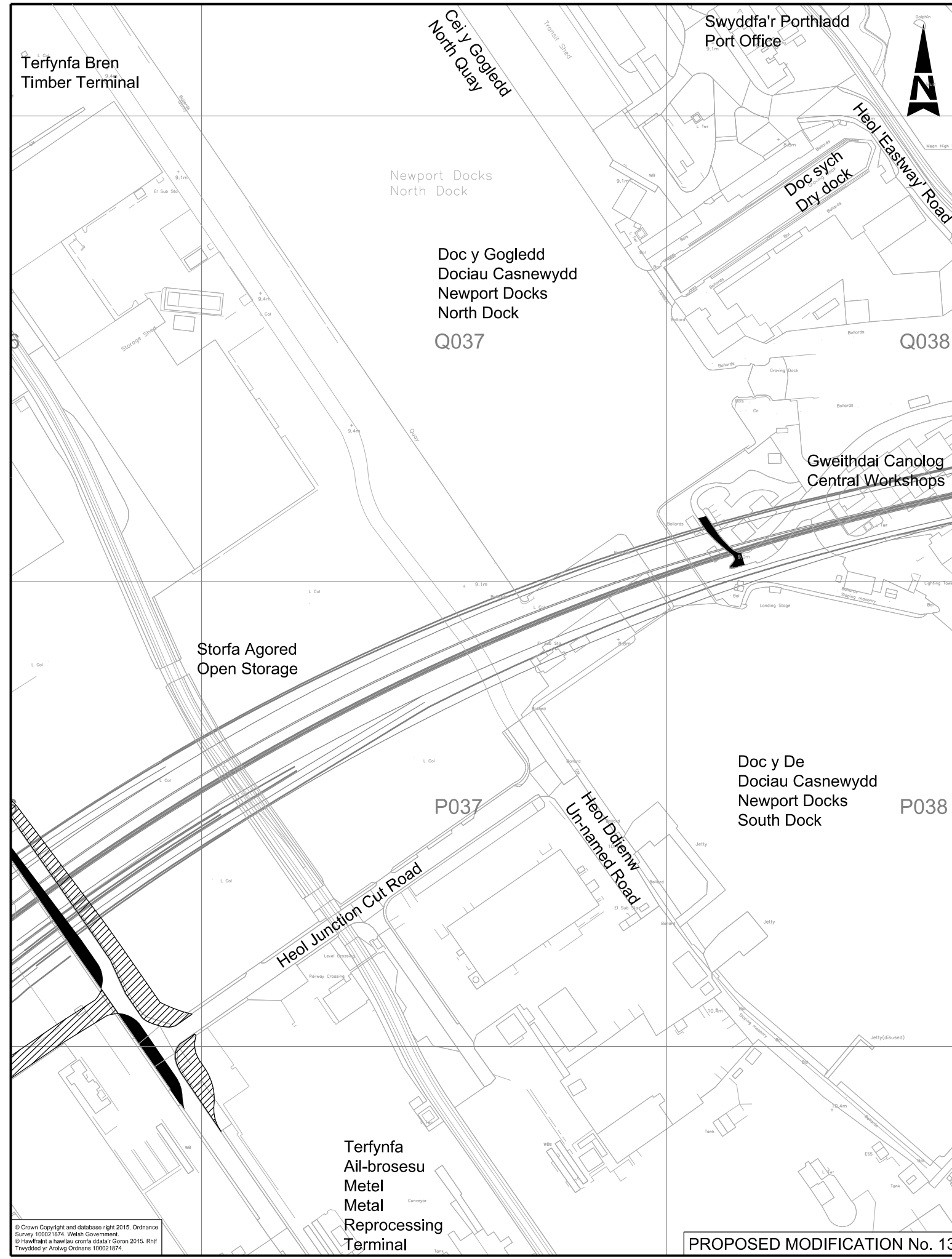

PROPOSED MODIFICATION No. 13

GORCHYMYN TRAFFORDD YR M4 (CYFFORDD 23 (MAN I'R DWYRAIN O FAGWYR) I FAN I'R GORLLEWIN O GYFFORDD 29 (CAS-BACH) A FFYRDD CYSYLLTU) A THRAFFORDD YR M48 (FFORDD GYSYLLTU CYFFORDD 23 (MAN I'R DWYRAIN O FAGWYR)) A CHEFNFFORDD LLUNDAIN I ABERGWAUN (MAN I'R DWYRAIN O FAGWYR I GAS-BACH) (FFYRDD YMYL) 201-

Nid yw'r cynlluniau yma yn dangos lled na manylion lluniadol

GRADDFA'R CYNLLUN ALLWEDDOL 1:10,000
GRADDFA'R CYNLLUN SAFLE 1:2500, 1:1250, 1:1000 & 1:500

UNEDAU HYD:
1 MEDR = ODDEUTU 1.094 LLATH
1 CILOMEDR = ODDEUTU 0.621 MILLTIR

THE M4 MOTORWAY (JUNCTION 23 (EAST OF MAGOR) TO WEST OF JUNCTION 29 (CASTLETON) AND CONNECTING ROADS) AND THE M48 MOTORWAY (JUNCTION 23 (EAST OF MAGOR) CONNECTING ROAD) AND THE LONDON TO FISHGUARD TRUNK ROAD (EAST OF MAGOR TO CASTLETON) (SIDE ROADS) ORDER 201-

These plans do not show widths or constructional details

KEY PLAN SCALE 1:10,000
SITE PLAN SCALE 1:2500, 1:1250, 1:1000 & 1:500

UNITS OF LENGTH
1 METRE = 1.094 YARDS APPROX
1 KILOMETRE = 0.621 MILES APPROX

ALLWEDD	KEY
Llwybr y brif gefnffordd newydd mewn cloddiaid	Route of new main special trunk road in cutting
Llwybr y brif gefnffordd newydd ar arglawdd	Route of new main special trunk road on embankment
Y ffyrdd arbennig presennol	Existing special roads
Priffordd newydd	New Highway
Priffordd i'w gwella	Highway to be improved
Priffordd i'w chau	Highway to be stopped up
Mynedfa breifat newydd	New private means of access
Mynedfa breifat i'w chau	Private means of access to be stopped up
Priffordd Dros Dro	Temporary Highway

Cofrestrriad Cynlluniau Plans Registry

Rhif. HA
No. HA

Dyddiad:
Date:

Llofnodwyd ar ran Gweinidogion Cymru Signed on behalf of the Welsh Ministers

Ar yr / On the

Pennaeth Rheoli Asedau a Safonau Llywodraeth Cymru

Head of Asset Management and Standards Welsh Government

Nodiadau er gwybodaeth:
Notes for Information:

- Ffin y briffordd Highway boundary
- Ffordd Cyhoeddus Public Right of Way
- Plot heb ei ddiwygio Unamended plot
- Plot wedi'i ddiwygio Amended plot

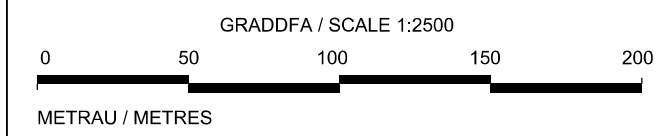

GORCHYMYN TRAFFORDD YR M4 (MAN I'R DWYRAIN O GYFFORDD 23 (MAGWYR) I FAN I'R GORLLEWIN O GYFFORDD 29 (CAS-BACH)) A FFYRDD CYSYLLTU (FFYRDD YMYL) 201-

THE M4 MOTORWAY (EAST OF JUNCTION 23 (MAGOR) TO WEST OF JUNCTION 29 (CASTLETON)) AND CONNECTING ROADS (SIDE ROADS) ORDER 201-

SIDE ROADS ORDER MODIFICATION NO. 13